

WIRE BASKET ULTRA SONIC DIFFUSER MANUAL

This ultra sonic diffuser uses the latest vibration technology to separate essential oil molecules before they are released into the air in their purest form, as a fine cool aromatic mist.

INCLUDED

Main Unit
AC Adaptor: Input 100~240V.a.c Output 24V.d.c

DIFFUSER PARTS

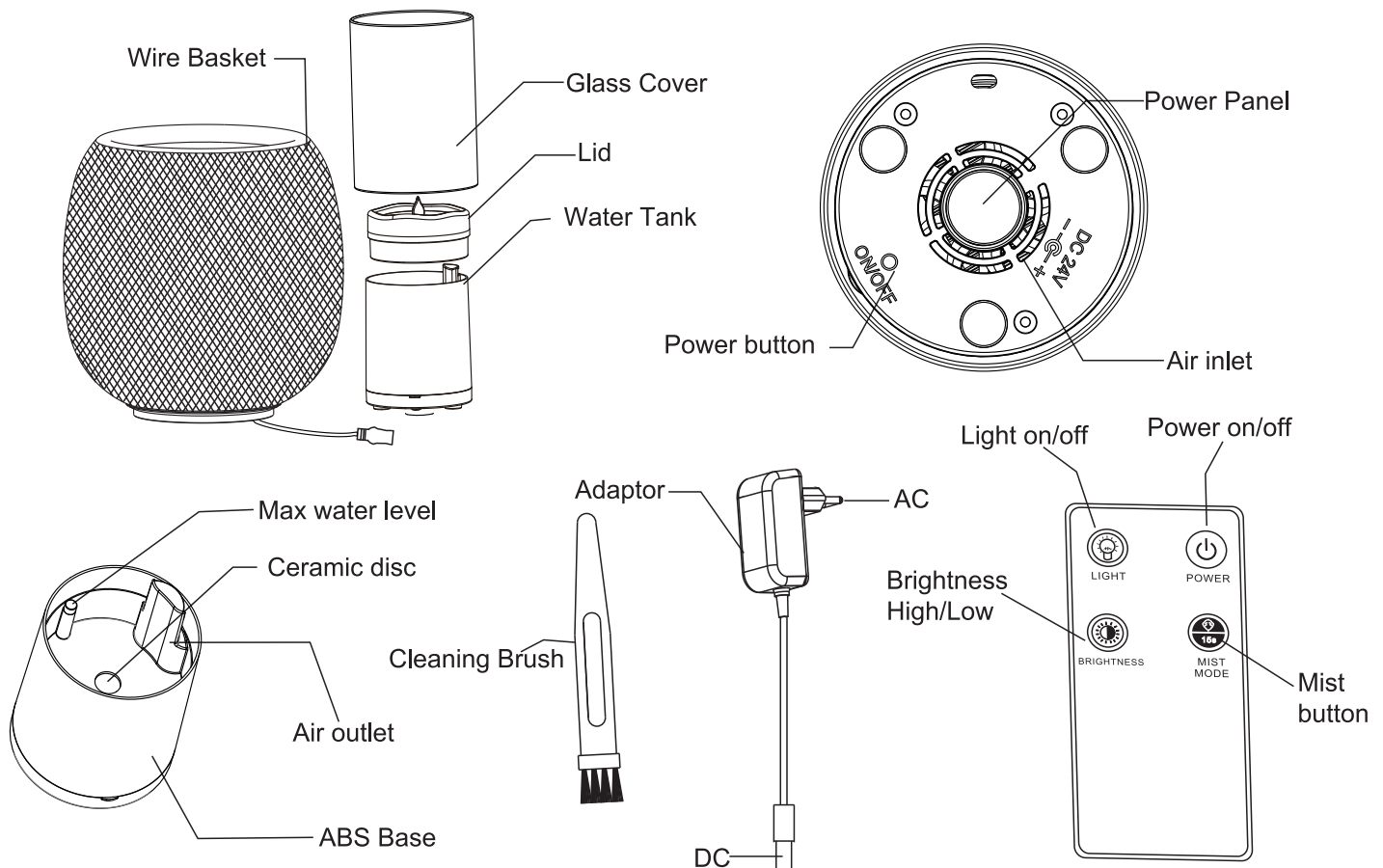

FEATURES

■ Power Button on the Diffuser (Located at the Bottom of the Water Tank)

PRESS ONCE for continuous mist mode. Mist and bright light setting will work continuously for 3 hours until auto shut off.

PRESS TWICE for intermittent mist mode. Mist will work in 15 second on/off cycles with bright light function for 6 hours until auto shut off.

PRESS THREE TIMES to turn the diffuser off.

■ Button Instructions on the Controller Functions

► Power

PRESS ONCE to turn on continuous mist mode and light (brightness level will be saved from last shut off). Diffuser will work for 3 hours until auto shut off.

PRESS TWICE to turn the diffuser off.

► Light

PRESS ONCE to turn on light only (brightness level saved before last shut off).

PRESS TWICE to turn on candle flicker mode.

PRESS THREE TIMES to turn light off.

► Mist Mode

PRESS ONCE for intermittent mist mode only. Mist will work in 15 second on/off cycles for 6 hours until auto shut off.

PRESS TWICE to turn on continuous mist mode only. Mist will work continuously for 3 hours until auto shut off.

► Brightness

PRESS ONCE for dim light.

PRESS TWICE for bright light.

■Auto Shut Off

The auto shut off is an important safety feature of the diffuser. Once all the water in the tank evaporates, the diffuser will automatically turn off to protect from damage or burning.
The diffuser will also auto shut off if abnormal overheating occurs.

■Water Tank Capacity: 100ml.

OPERATION

Avoid essential oil from dropping onto the wire basket as this may cause damage.

- ① Remove Glass Cover and Water Tank from the Wire Basket.
- ② Remove the lid from the water tank.
- ③ Fill water tank to the maximum water level indicator. Add 6-9 drops in total of essential oil.

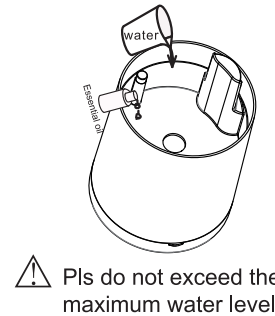
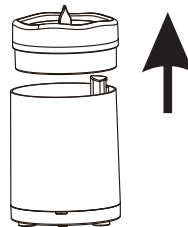
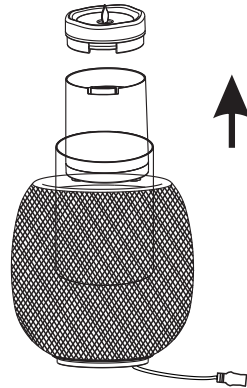

- ④ Replace the lid of the water tank and place into the wire basket, making sure the POWER button at the bottom of the water tank lines up with the hole at the bottom of the basket. Replace glass cover.
- ⑤ Attach the power cord to the diffuser and insert the plug into the power socket.
- ⑥ Press POWER to turn on the diffuser.

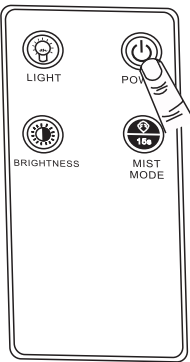
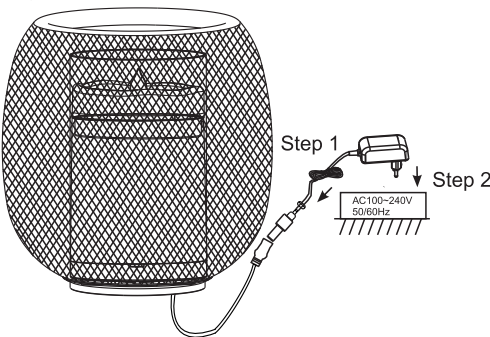
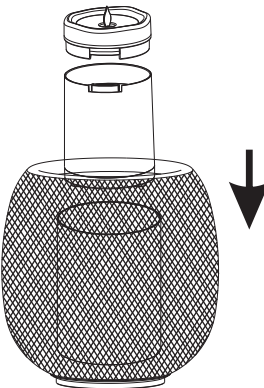

TROUBLE SHOOTING

If your diffuser is not working properly once the above steps have been followed, please try the following:

Problems	Possible Reasons	Resolutions
Diffuser is not turning on	Power not connected	Connect the power as per step 5 above and press the POWER button.
	Cable is broken or adapter has burnt out	Do not try to turn on the diffuser. Please contact Customer Service on 1300 650 981.
Mist is not diffusing	Water level is too low	Please fill the water tank to the maximum fill line
	Water level is too high	Ensure maximum water level is not exceeded
	Ceramic disc or water tank is dirty	Rinse out the tank and wipe clean the ceramic disc
	Water tank lid is not on correctly	Ensure top lid is on properly
	Bottom air inlet is dirty	Wipe clean the bottom air inlet
Water tank is leaking	Water tank lid is not on correctly	Ensure top lid is on properly
	Room temperature is too low or too humid	Low temperature and humidity may cause the diffuser to malfunction.